

Note:
All dimensions to be checked on site & against Eng. drawings, prior to fabrication

Section G-G
1:75@A1

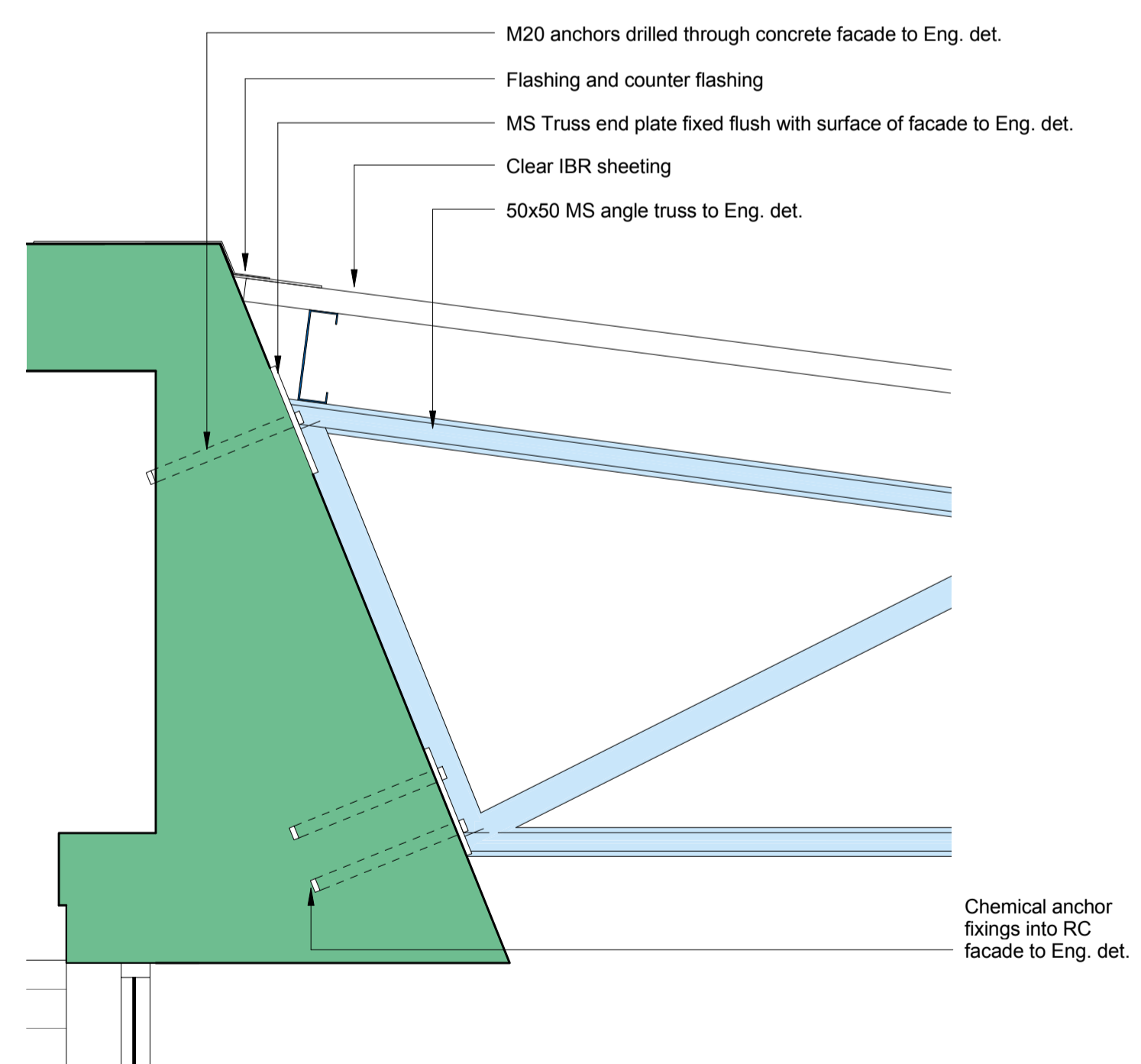

D1 - New Roof Canopy Fixing Detail
1:10@A1

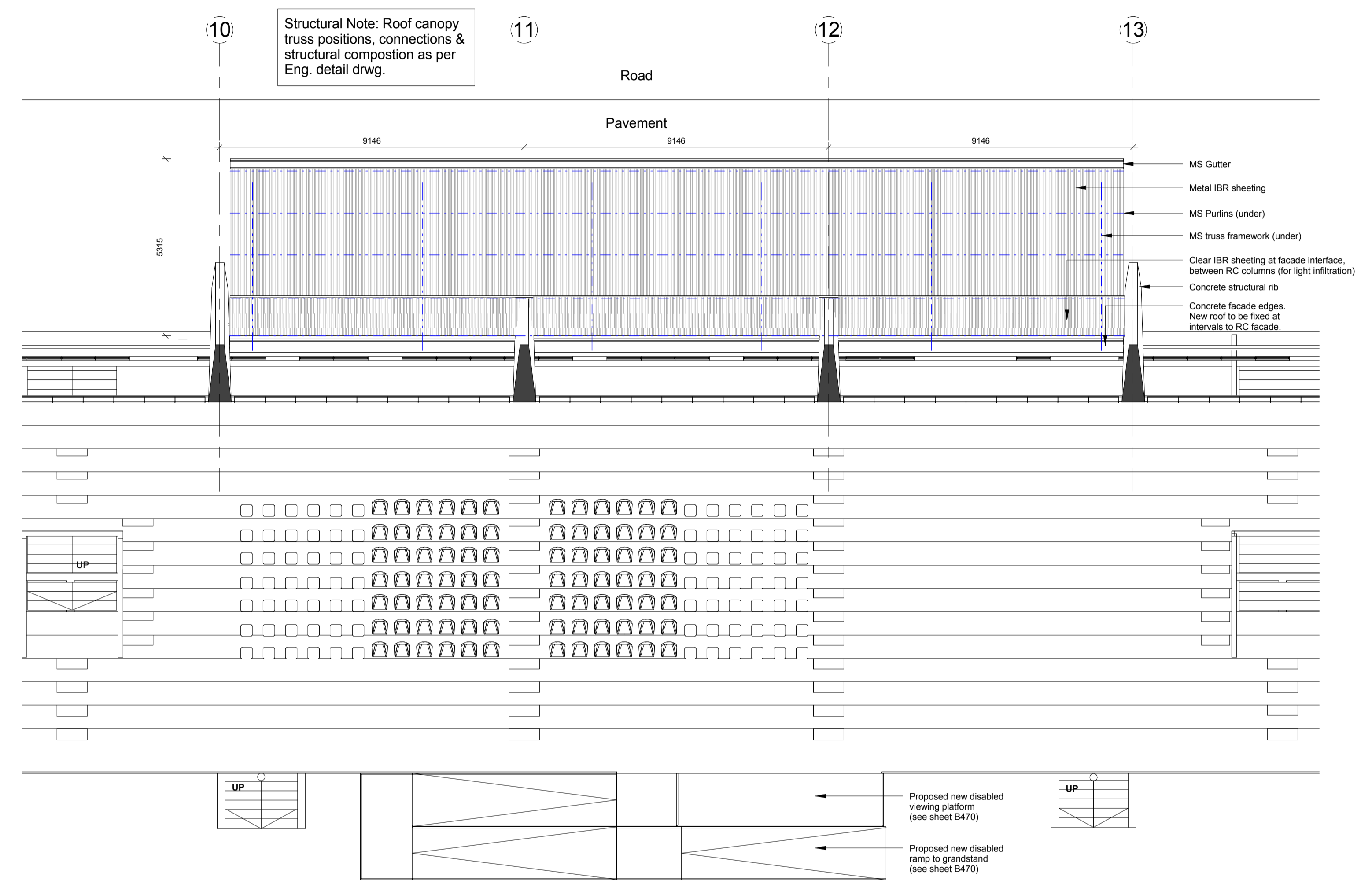

New Roof Canopy Plan
1:100@A1

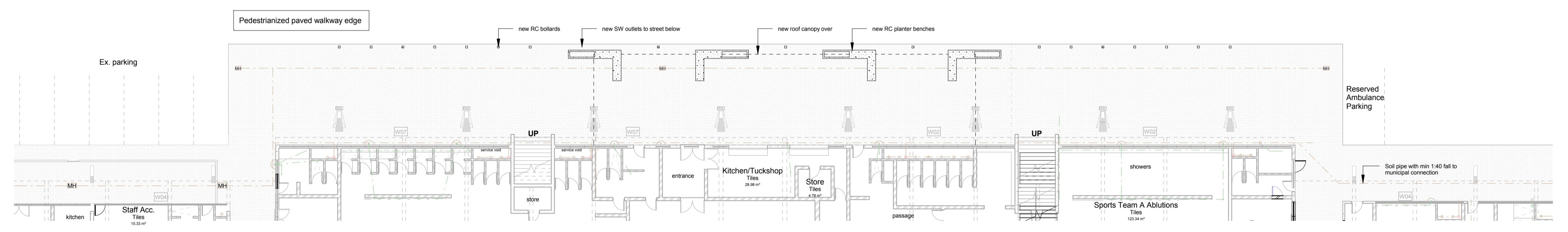

New Pedestrian Zone Plan
1:200@A1

- GENERAL NOTES:**
- All dimensions taken on site and on drawings, any discrepancies to be reported to architect before work is put in hand.
 - Only figured dimensions to be taken.
 - All levels to be checked on site and on drawings, any discrepancies to be reported to the Architect before any work is put in hand.
 - All structural work to be checked by an Engineer, all work to be in accordance with SANS - 10400.
 - Soil conditions to be approved by soil Engineer.
 - The drawing is the property of 26'10 south Architects.
- Copyright is reserved by them and the drawing is issued on the condition that it is not copied, reproduced, retained or disclosed to any unauthorized person, either wholly or in part without the written consent of 26'10 south Architects before any work is put in hand.

- DRAINAGE NOTES:**
- All drainage to comply with NBR as per SANS - 10400 Part P.
 - All pipes passing under the building to be protected against the loads of the structure.
 - Rodding eye's at all changes of direction of drain.
 - Inspection eye's at all bends and junctions of drain.
 - Reseal traps to all waste fittings.
 - Waste pipes to be fully accessible along entire length.
 - No bends and junctions under building.
 - All work to comply with Local Authority by-laws.
 - Open vent pipe at the highest point of the plumbing installation

NOTES:

REV:	DATE:	DESCRIPTION:
1	17.10.31	Council & Tender Info
2	17.11.28	Call for Tender

CLIENT: WITS UNIVERSITY
PROJECT: Wits Hockey Stadium
PROJ. NO.: 116HOC
STAND NO.: Erven 132-135,145-148, 804,1/858 &RE/858
TOWNSHIP: Parktown
DWG TITLE: NEW ROOF CANOPY - SECTIONS & PLANS

DWG NO.:	B460
REV NO.:	2
DATE:	17.11.28
SCALE:	As indicated
DRAWN BY:	PW
CHECKED BY:	SF

26'10 SOUTH ARCHITECTS

P.O. Box 291814 Melville 2109 Johannesburg South Africa
t: +27 (0) 11 830 0220
f: +27 (0) 11 830 0268
e: info@2610south.co.za